

MALTA TOWNSHIP SECTION 8 R-12 TWP-10 MORGAN COUNTY, OH

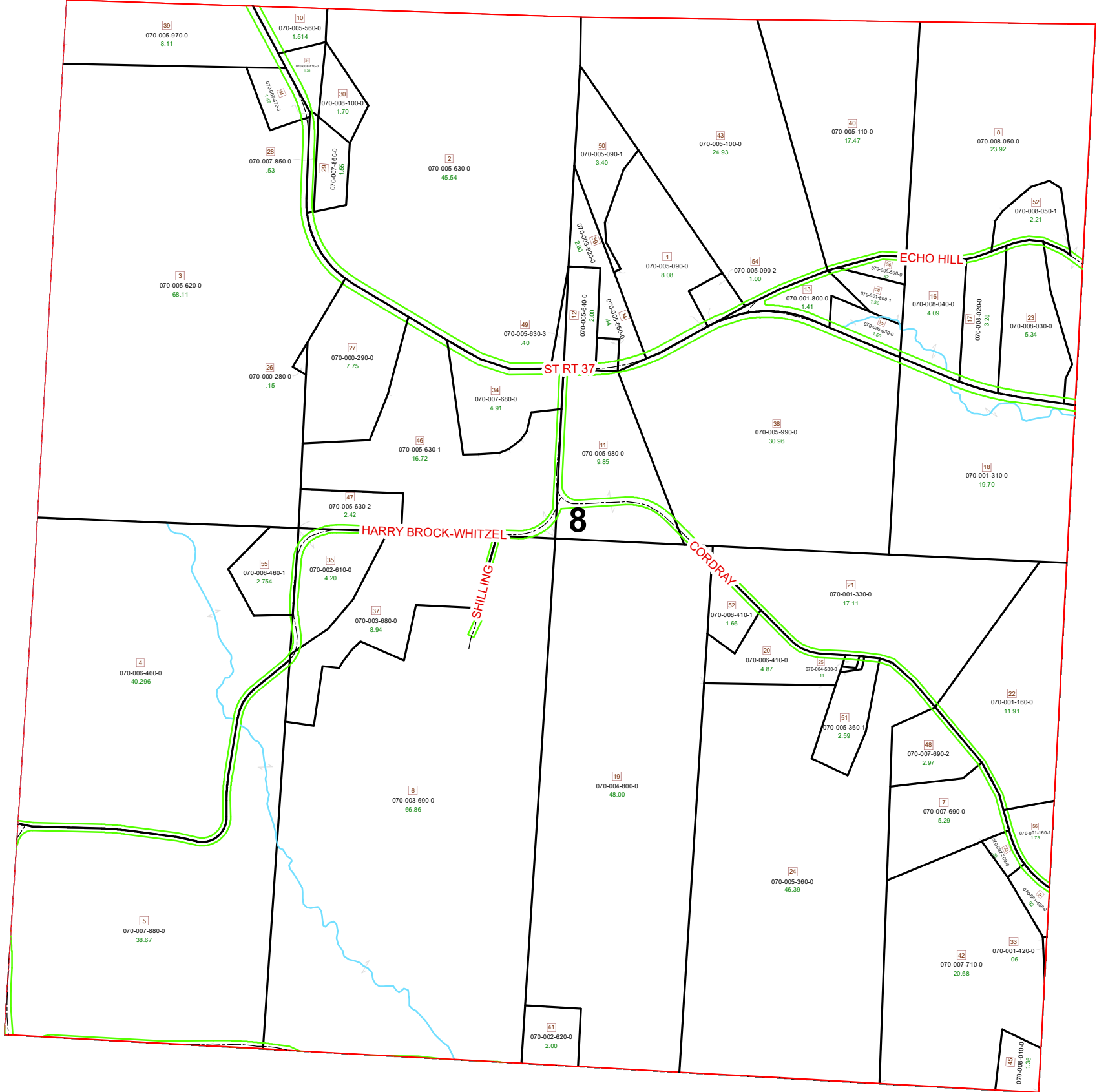

PIN	VOL	PAG	Owner	LegalDescr	Acres
070-000-280-0	D.V	192 736	BANKES MAXINE M	R12 T10 S08 SD 26	0.15
070-000-290-0	D.V	192 736	BANKES MAXINE M	R12 T10 S08 SD 27	7.75
070-000-590-0	D.V	149 551	BOYER ARTHUR B & SUSAN M	R12 T10 S08 SD 36	0.67
070-001-800-1	OR145	229	BOYER ARTHUR BARRY & SUSAN M	R12 T10 S08 SD 53	1.304
070-006-460-1	OR212	2980	BURDETTE ROBERT L & MARIA L	R12 T10 S08 SD 55 S	2.754
070-001-330-0	OR41	385	CORNELL TERRI LYNN & PARMITER ALVIN BARRY, DAVIS P	R12 T10 S08 SD 21 T	17.11
070-001-310-0	OR41	385	CORNELL TERRI LYNN & PARMITER ALVIN BARRY, DAVIS P	R12 T10 S09 SD 18 T	19.7
070-002-620-0	OR3	558	DAVIS JOHN D & REBECCA J C/O DONNA DAVIS	R12 T10 S08 SD 41 S	2
070-001-160-0	D.V	198 301	GEORGE GEORGE ALLEN & STACEY B	R12 T10 S08 SD 22	12.357
070-005-550-0	OR234	210	HALL PHILLIP E & JUDY L SURVIVORSHIP	R12 T10 S08 SD 15	1.5
070-004-800-0	OR207	437	HOLLAND JUSTIN D & LUCINDA S	R12 T10 S08 SD 19 S	48
070-002-610-0	OR233	656	HOSOM JULIA R	R12 T10 S08 SD 35	4.2
070-005-090-1	OR200	546	LIFF DANNY & LORA	R12 T10 S08 SD 50	3.402
070-003-920-0	OR231	2417	LIFF ROSE M TOD LIFF DANNY J AND LORA LOUISE	R12 T10 S08 SD 39	2.9
070-008-050-1	OR10	764	MAIN STREET CHURCH OF CHRIST	R12 T10 S08 SD 52	2.21
070-005-560-0	OR233	2226	MAXWELL CARISSA L	R12 T10 S08 SD 10	1.514
070-005-100-0	OR232	1054	MAYLE BRYAN K II & KELSIE N	R12 T10 S08 SD 43	24.93
070-007-690-0	OR177	267	MAYLE JEFF T & ELAINE	R12 T10 S08 SD 7 SU	5.291
070-004-530-0	OR234	1670	MAYLE MARY	R12 T10 S08 SD 25	0.11
070-001-800-0	OR230	3027	MAYLE TAMMIE S AKA MAYLE TAMMIE SUE	R12 T10 S08 SD 13	1.416
070-005-110-0	OR233	212	MILLER JOHN A & EMMA IRENE	R12 T10 S08 SD 40	17.47
070-005-090-2	OR233	4851	MILLER JOHN A & TITUS MILLER & WANDA M BELER ETAL	R12 T10 S08 SD 54	1.005
070-005-090-0	OR6	15	MILLER JOHN ANDREW & E IRENE	R12 T10 S08 SD 1	8.083
070-005-360-1	OR230	2908	NORMAN THOMAS D	R12 T10 S08 SD 51 L	2.596
070-005-620-0	OR222	748	PORTER FRANCIS S & MOLLY JOAN TRUST	R12 T10 S08 SD 3	68.11
070-005-970-0	D.V	142 561	RICHARDSON DEAN & JOY	R12 T10 S08 SD 39	8.11
070-005-990-0	D.V	141 311	RICHMOND ROBERT N & SALLY F TOD-PATRICIA GLAZE	R12 T10 S08 SD 38	30.96
070-005-980-0	D.V	127 341	RICHMOND ROBERT N TOD-PATRICIA GLAZE	R12 T10 S08 SD 11	9.85
070-005-360-0	OR67	363	ROBB JOSEPH D & VICTORIA S	R12 T10 S08 SD 24 S	46.394
070-006-410-1	OR207	13	ROBERTS SHANE & BRENDA	R12 T10 S08 SD 52 S	1.668
070-006-410-0	D.V	141 67	SANDERS JOHN F & LINDA K	R12 T10 S08 SD 20	4.872
070-001-160-1	OR230	450	SHOOK SHAUNTEL J	R12 T10 S8 SD56	1.738
070-005-650-0	D.V	199 461	TRIPLET STACEY B & M JANE C/O MUTUAL FEDERAL SAV B	R12 T10 S08 SD 14 S	0.44
070-005-640-0	D.V	199 461	TRIPLET STACEY B & M JANE C/O MUTUAL FEDERAL SAV B	R12 T10 S08 SD 12 S	2
070-005-630-3	D.V	199 461	TRIPLET STACEY B & M JANE C/O MUTUAL FEDERAL SAVIN	R12 T10 S08 SD 49 S	0.405
070-001-400-0	OR206	2224	VINCENT LARRY JARED	R12 T10 S08 SD 9	0.922

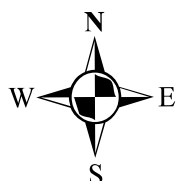

Boundaries	
----- Hidden	----- ROW
----- Hydro	----- Section
----- Roads	----- Lot
----- County	----- Township
----- Parcel	----- Parcels



Disclaimer: The information that these maps contains is for reference purposes only. Please bring any erros to the attention of the Engineer's Office staff.
Thank you

Source: Morgan County Engineer's Office
Author: Marcia Wolfe
Date: 6/17/2020

MALTA TOWNSHIP SECTION 8 R-12 TWP-10 MORGAN COUNTY, OH

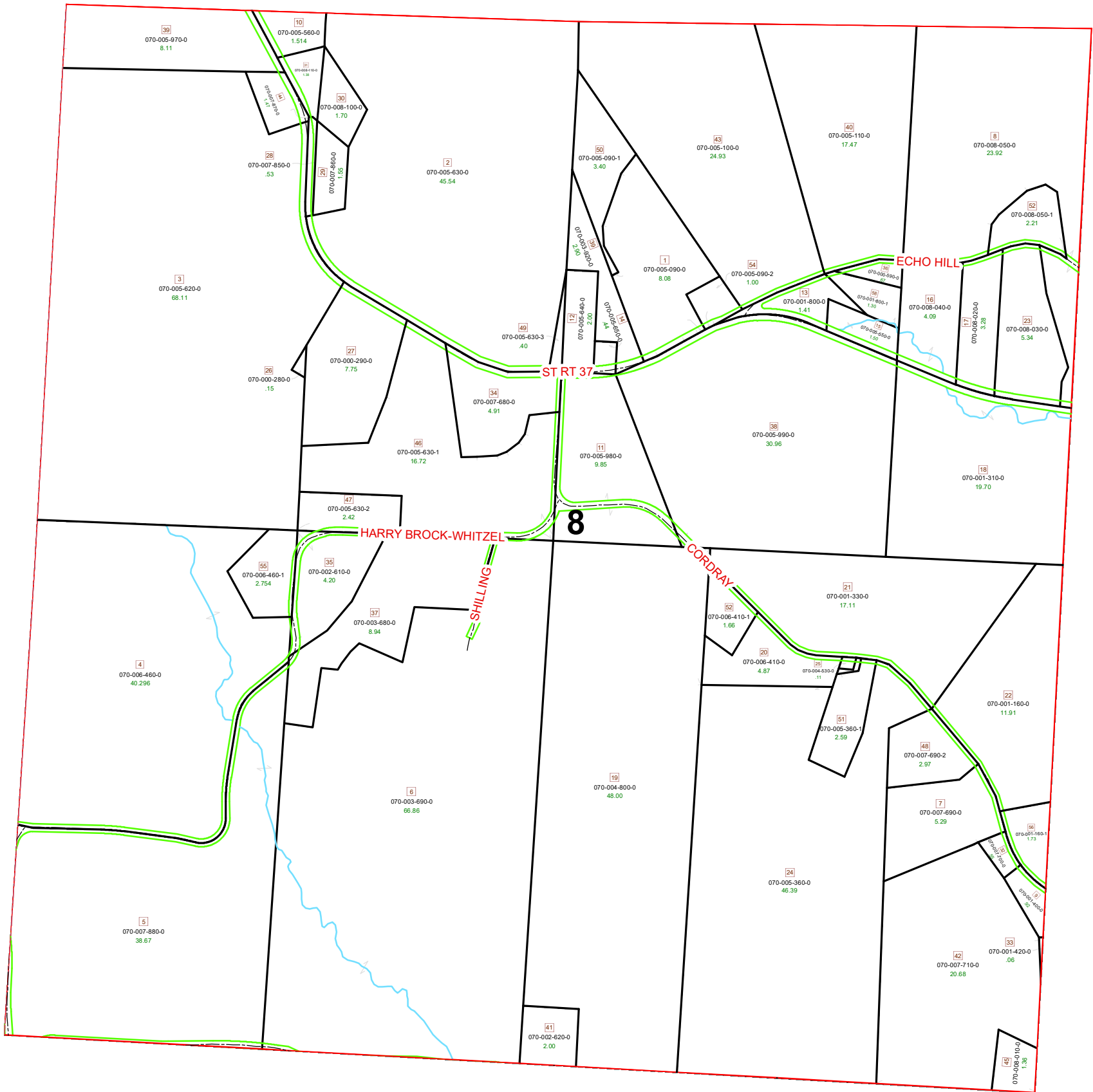

PIN	VOL	PAG	Owner	LegalDescr	Acres
070-003-680-0	OR233	3416	WESTFALL DAKOTA L & DRAKE V KING	R12 T10 S08 SD 37	8.94
070-003-690-0	OR233	4448	WESTFALL LUCILLE L & MARK A	R12 T10 S08 SD 6	66.86
070-005-630-1	D.V 188	216	WESTFALL LUCILLE L TOD-MARK A WESTF	R12 T10 S08 SD 46	16.72
070-007-680-0	D.V 194	788	WESTFALL LUCILLE L TOD-RITA D MURPHY	R12 T10 S08 SD 34	4.91
070-005-630-2	D.V 192	715	WESTFALL MARK A & ANGELA K	R12 T10 S08 SD 47 S	2.425
070-007-690-2	OR230	2118	WESTFALL PATRICK R & CAROL S	R12 T10 S08 SD 48 S	2.979
070-007-710-0	OR231	1989	WESTFALL PATRICK R, ET2AL	R12 T10 S08 SD 42	20.683
070-007-700-0	OR231	1989	WESTFALL PATRICK R, ET2AL	R12 T10 S08 SD 32	0.55
070-007-870-0	D.V 166	298	WILSON JAMES B & LINDA R	R12 T10 S08 SD 44	1.47
070-005-630-0	D.V 187	736	WILSON JAMES B & LINDA R	R13 T10 S08 SD 2	45.54
070-007-860-0	D.V 128	265	WILSON JAMES BAILEY & LINDA	R12 T10 S08 SD 29	1.55
070-007-850-0	D.V 128	269	WILSON JAMES BAILEY & LINDA	R12 T10 S08 SD 28	0.53
070-006-460-0	OR112	3448	WILSON MARK D & CINDY L	R12 T10 S08 SD 4 SU	40.296
070-007-880-0	OR233	5663	WISEMAN RUSSELL E & DEE A	R12 T10 S08 SD 5	38.67
070-008-010-0	OR217	2169	WORK TINA J & DEMETRIA D	R12 T10 S08 SD 45 E	1.367
070-008-020-0	OR144	228	WRIGHT JOHN W & MARTHA A	R12 T10 S08 SD 17 S	3.28
070-008-030-0	OR144	228	WRIGHT JOHN W & MARTHA A	R12 T10 S08 SD 23 S	5.34
070-008-050-0	OR144	228	WRIGHT JOHN W & MARTHA A	R12 T10 S08 SD 8 SU	23.92
070-008-040-0	OR144	228	WRIGHT JOHN W & MARTHA A	R12 T10 S08 SD 16 S	4.09
070-008-100-0	OR228	3307	YOUNG TERRY EDWIN & CAROL ANN TOD:	R12 T10 S08 SD 30	1.7
070-008-110-0	OR228	3307	YOUNG TERRY EDWIN & CAROL ANN TOD:	R12 T10 S08 SD 31	1.38

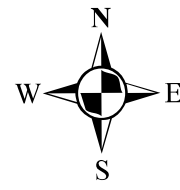

Boundaries	
-----	Hidden
-----	Roads
-----	County
-----	Parcel
-----	Parcels
-----	Hydro
-----	Lot
-----	Township
-----	Section
-----	ROW

Source: Morgan County Engineer's Office
 Author: Marcia Wolfe
 Date: 6/17/2020



Disclaimer: The information that these maps contains is for reference purposes only. Please bring any erros to the attention of the Engineer's Office staff.
 Thank you